

**SUMMERLAND COMMUNITY PLAN
ZONING DISTRICTS
ARTICLE II AND ARTICLE III**

LEGEND

OPEN LAND USES		COMMERCIAL
AG-1	AGRICULTURE I 5 to 40 acre minimum parcel size	C-1 LIMITED COMMERCIAL
REC	RECREATION	INDUSTRIAL
RESIDENTIAL		M-RP INDUSTRIAL RESEARCH PARK
RR	RURAL RESIDENTIAL 1 unit/5 acres to 1 unit/100 acres	OTHER
SINGLE FAMILY		PU PUBLIC UTILITIES
3-E-1	3 acres	TC TRANSPORTATION CORRIDOR
2-E-1	2 acres	BOUNDARIES
1-E-1	1 acres	URBAN/RURAL
20-R-1	20,000 sq. ft.	RURAL NEIGHBORHOOD
10-R-1	10,000 sq. ft.	COASTAL ZONE
7-R-1	7,000 sq. ft.	COMMUNITY PLAN
MULTIPLE		OVERLAY DISTRICT
10-R-2 (two family)	10,000 sq. ft.	-SUM includes ALL parcels within the COMMUNITY PLAN BOUNDARY
DR (design residential)	none	
MHP (mobile home park)	5 acres	

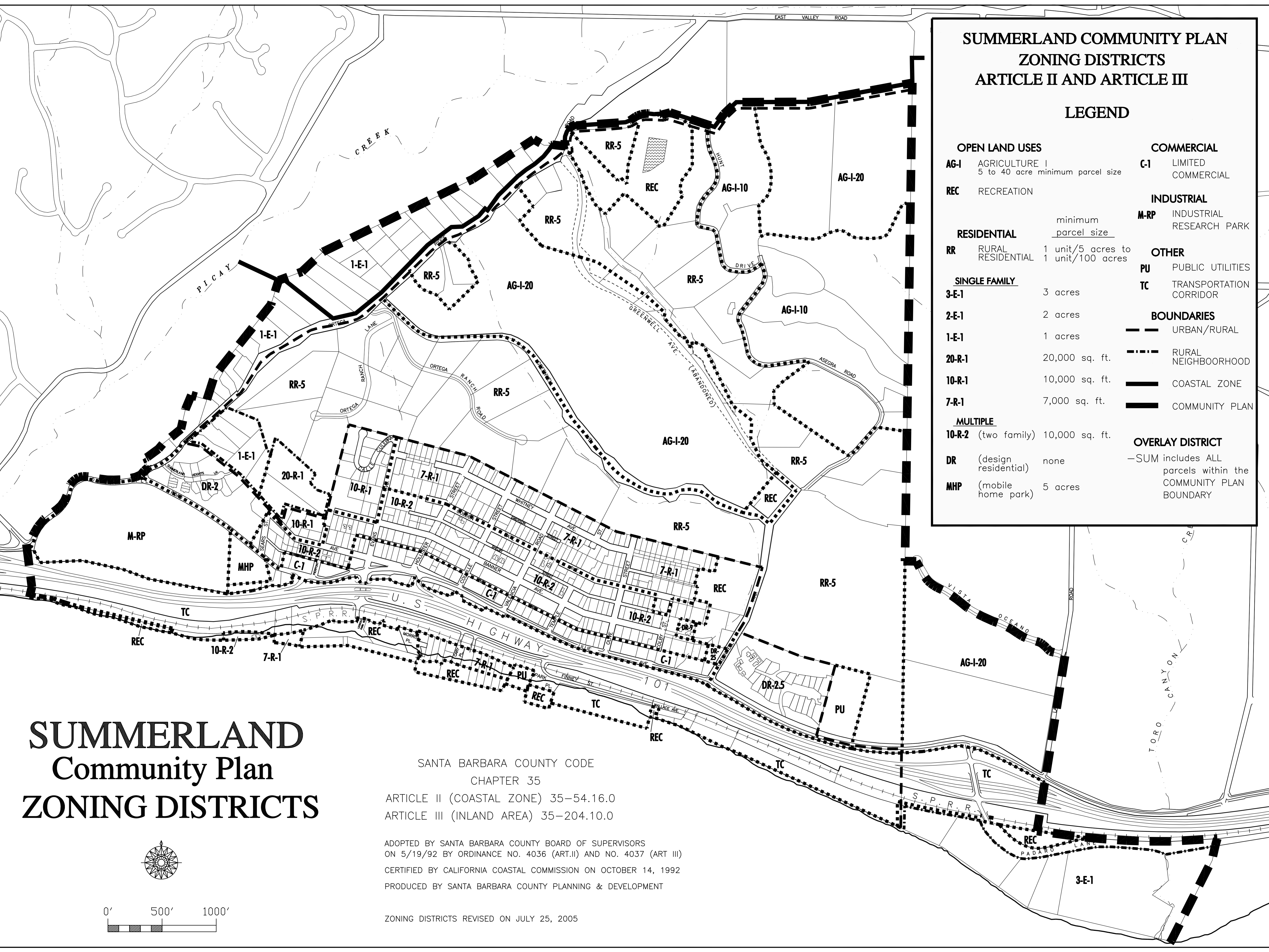

**SUMMERLAND
Community Plan
ZONING DISTRICTS**

SANTA BARBARA COUNTY CODE
CHAPTER 35
ARTICLE II (COASTAL ZONE) 35-54.16.0
ARTICLE III (INLAND AREA) 35-204.10.0

ADOPTED BY SANTA BARBARA COUNTY BOARD OF SUPERVISORS
ON 5/19/92 BY ORDINANCE NO. 4036 (ART.II) AND NO. 4037 (ART III)
CERTIFIED BY CALIFORNIA COASTAL COMMISSION ON OCTOBER 14, 1992
PRODUCED BY SANTA BARBARA COUNTY PLANNING & DEVELOPMENT

ZONING DISTRICTS REVISED ON JULY 25, 2005

