

2003-2008 Housing Element  
Focused Rezone Program

Santa Barbara County  
Planning Commission  
November 12, 2008



**OFFICE OF LONG RANGE PLANNING**

1

## Presentation Overview

- Selection of Rezone Sites
- Enhanced Community Plan Design Standards and Review Process



**OFFICE OF LONG RANGE PLANNING**

[longrange.sbcountyplanning.org](http://longrange.sbcountyplanning.org)

2

## Discussion of Sites

- Five EIR Alternatives
- Proposed Project: Key Sites 3 and 30
  - Key Site 3 Rezone “Envelope” Options
  - Key Site 30



OFFICE OF LONG RANGE PLANNING

longrange.sbcountyplanning.org<sup>3</sup>

## Key Site 3 – Option A (Proposed Project)



OFFICE OF LONG RANGE PLANNING

4

# Key Site 3 – Option B

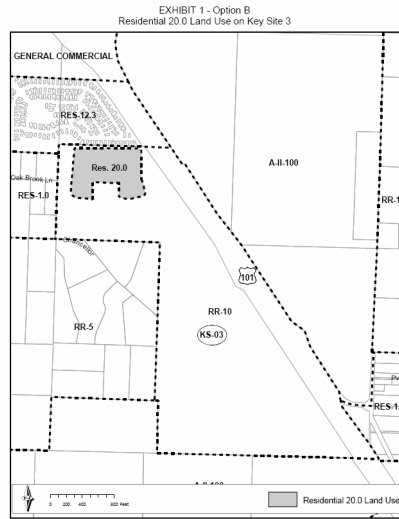

OFFICE OF LONG RANGE PLANNING



5

# Key Site 3 – Option C



OFFICE OF LONG RANGE PLANNING



6

# Key Site 3 – All Options

## Option A



## Option B

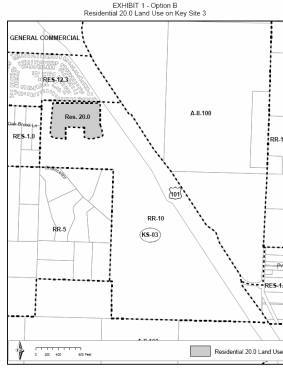

## Option C



OFFICE OF LONG RANGE PLANNING



# Key Site 30

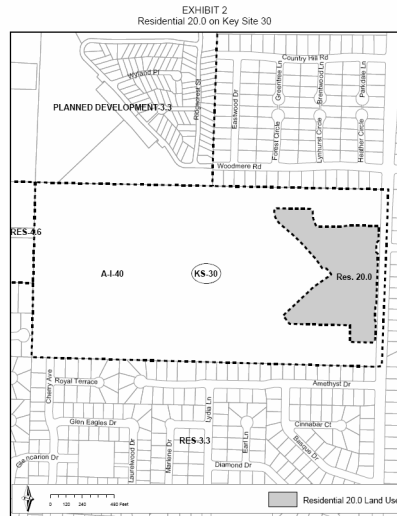

OFFICE OF LONG RANGE PLANNING



## Design Standards

- All Existing County Land-use Policies Still Apply
- Additional Design Components for Rezone Sites
- BAR and Director Review



## PC Recommendation

- That the Board certify the EIR and adopt the MMRP, Findings and SOC;
- Adopt the resolution recommending Board approval of the Focused Rezone Program;
- Adopt the implementing ordinances and resolutions reflecting the action to rezone Key Sites 3 and 30.

